



SAAD / 建築設計事務所

sudo associates, architecture and design

Main Works

- Elevation Plot-N
- Fenix Furano & West
- Niseko The Tower
- Roka
- Chalet Bark
- Millet Apartment
- River House
- Escarpment Plot - 24/25
- Elevation Plot - M
- Foxwood
- Escarpment Plot - 6/7
- HSC
- SDH
- Toyoura City Development Project

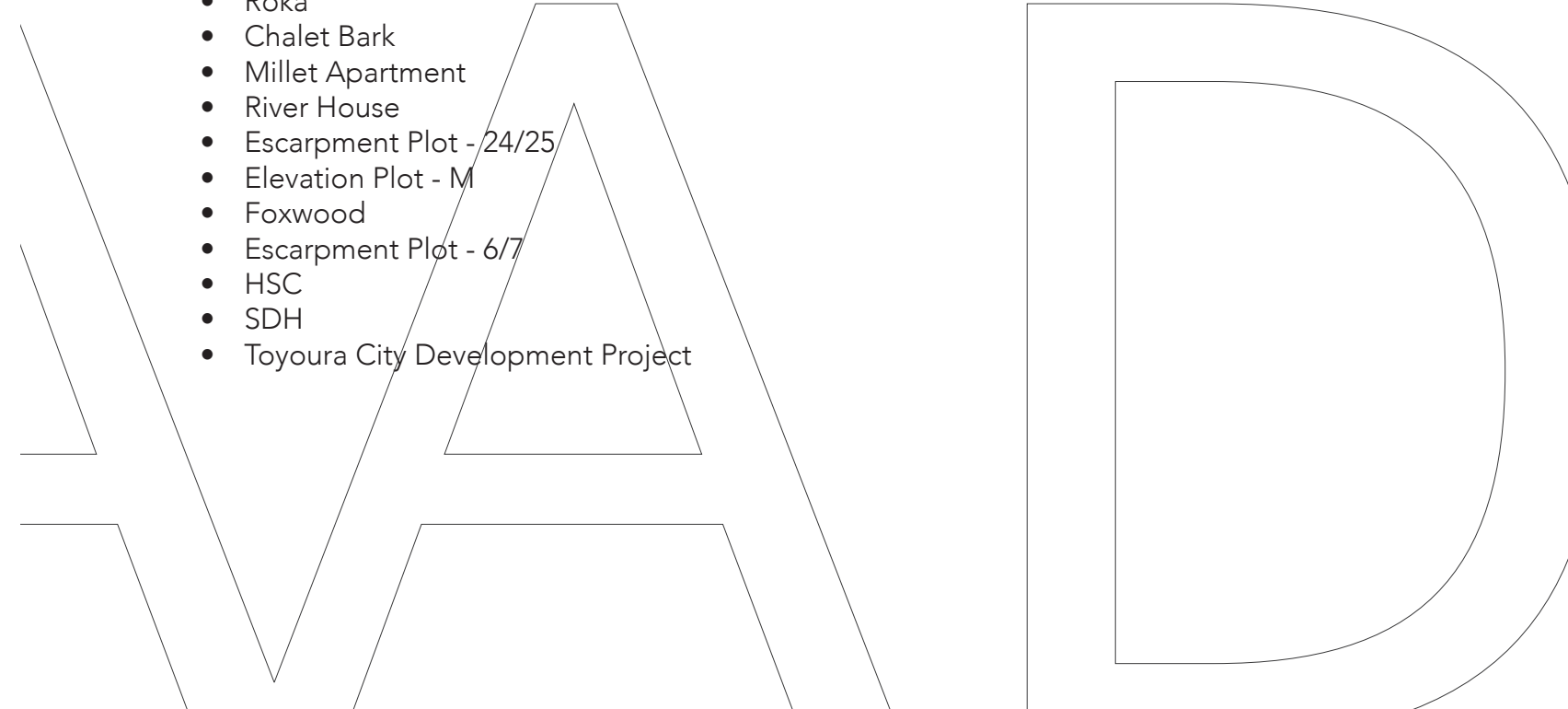



Elevation Plot-N

Completion: 2022.12

Use: Residence

Structure: RC

Site Area: 1,188.63sqm

Total Floor Area: 278.05sqm

Building Site: Kucchan, Hokkaido





Fenix West

Fenix West is under construction,
and Fenix East is under design process.

Completion: 2022.10

Use: Hotel

Structure: RC

Site Area: 1,016.12sqm

Total Floor Area: 2,054.92sqm

Building Site: Kitanomine city Furano, Hokkaido

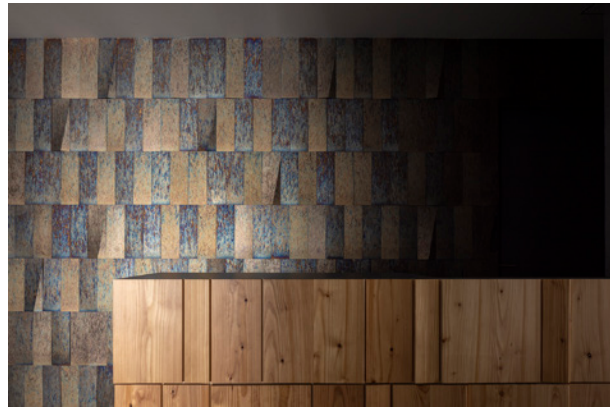



Fenix Furano

Completion: 2020.06

Use: Hotel

Structure: RC

Site Area: 1,767.07sqm

Total Floor Area: 3,530.89sqm

Building Site: Kitanomine city Furano, Hokkaido





Niseko The Tower

Completion: Concept

Use: Condominium / Commercial

Structure: Steel / RC

Site Area: 54,215sqm

Total Floor Area: 30,000sqm

Building Site: Kucchan, Hokkaido



ROKA

Completion: built
Use: Condominium / Commercial
Structure: Steel
Site Area: 955.72sqm
Total Floor Area: 1,525.04sqm
Building Site: Hakuba, Nagano





Kabayama Condominium Project

Completion: On process

Use: Condominium

Structure: RC

Site Area: 1193.97sqm

Total Floor Area: 2317.58sqm

Building Site: Kucchan, Hokkaido

A modern chalet with a complex, multi-tiered structure. The building features a mix of light-colored vertical wood slats and dark grey or black horizontal panels. The roof is dark and appears to be made of a different material, possibly metal or dark wood. The chalet is set in a winter landscape with snow-covered trees and a light blue sky with falling snow. The building is partially obscured by snow-laden branches in the foreground.

Chalet Bark

Completion: Unbuilt

Use: Residence / Hotel

Structure: Steel

Site Area: 526.26sqm

Total Floor Area: 189.04sqm

Building Site: Yamada Kucchan, Hokkaido

Millet Apartments

Completion: Unbuilt

Use: Hotel

Structure: RC

Site Area: 481sqm

Total Floor Area: 1355.38sqm

Building Site: Kitanomine city Furano, Hokkaido





River House

Completion: 2020.05

Use: Residence

Structure: Timber

Site Area: 1664.41sqm

Total Floor Area: 311.78sqm

Building Site: Niseko Abuta, Hokkaido



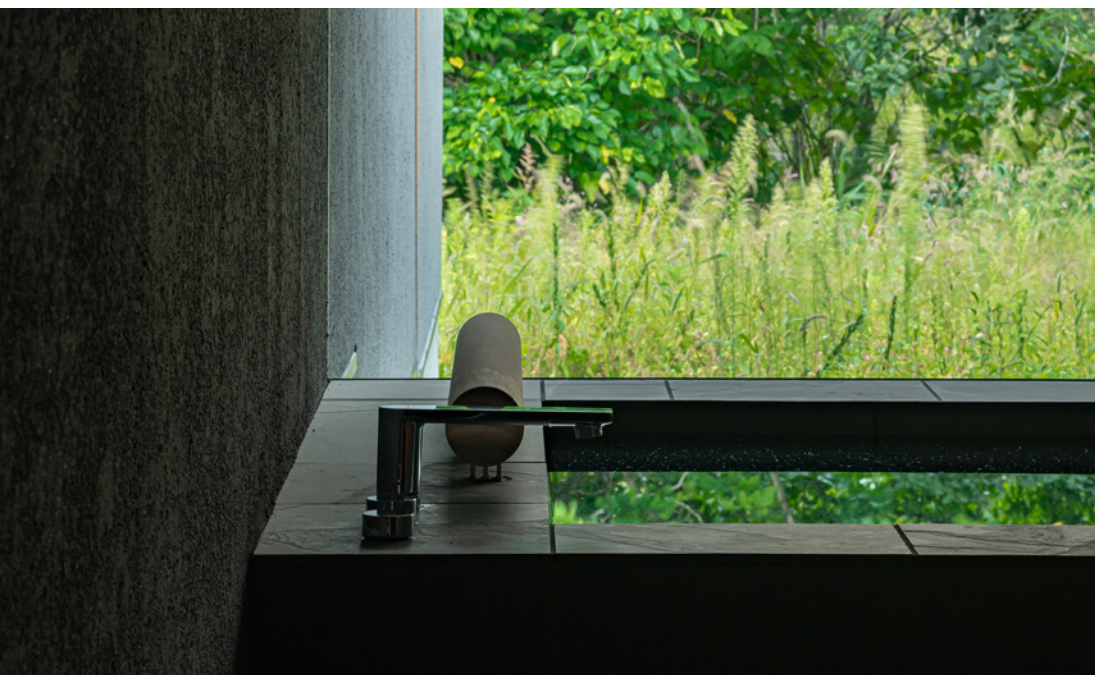

Escarpment Plot 24/25

Completion: 2018.11

Use: Residence / Hotel

Structure: RC

Site Area: 696.30sqm

Total Floor Area: 244.57sqm

Building Site: Yamada Kucchan, Hokkaido





Elevation Plot- M

Completion: 2017.03

Use: Residence

Structure: RC

Site Area: 1,183.97sqm

Total Floor Area: 3483.46sqm

Building Site: Yamada Kucchan , Hokkaido





An aerial photograph of a modern hotel complex in a snowy mountain landscape. The buildings feature light-colored vertical wood siding and dark grey lower levels. Large, irregularly shaped windows are prominent, some showing interior lights. The roofs are covered in snow, and the surrounding terrain is a mix of snow-covered ground and bare trees. In the background, other buildings and a forest are visible under a soft, overcast sky.

Foxwood

Completion: 2016.07~

Use: Hotel

Structure: Timber

Site Area: 437.72sqm

Total Floor Area: 195.61sqm

Building Site: Higashiyama Niseko , Hokkai-
do

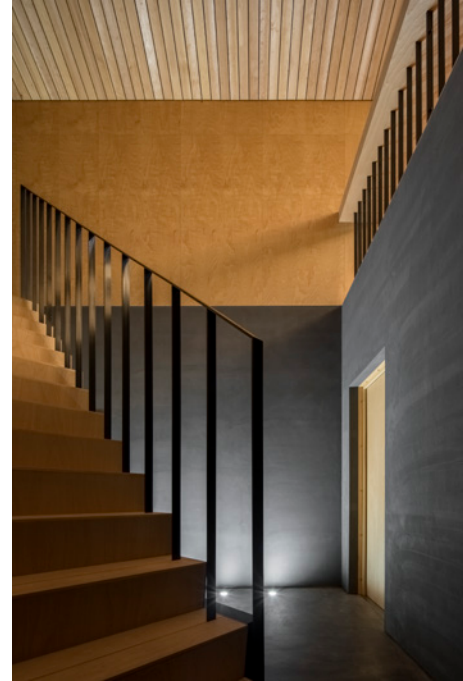

Escarpment Plot - 6/7

Completion: 2016.11
Use: Hotel
Structure: RC
Site Area: 1,053.70sqm
Total Floor Area: 390.15sqm
Building Site: Yamada Kucchan , Hokkaido



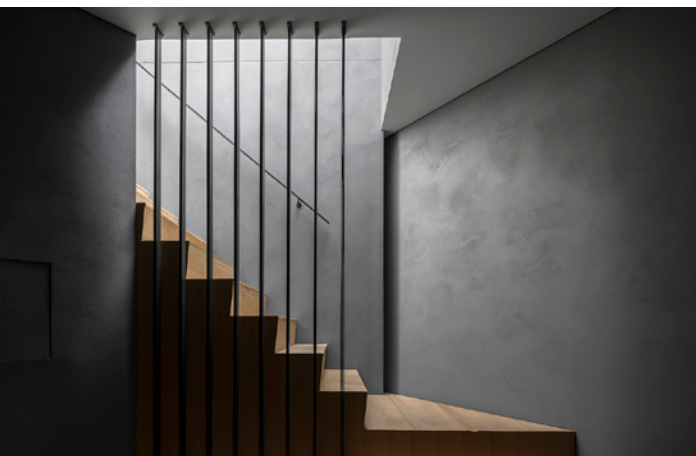

HSC

Completion: 2018.03

Use: Hotel

Structure: Timber

Site Area: 792.00sqm

Total Floor Area: 289.86sqm

Building Site: Kabayama Kucchan , Hokkaido





SDH

Completion: 2015.07

Use: Residence

Structure: Steel

Site Area: 710.42sqm

Total Floor Area: 311.22sqm

Building Site: Yamada Kucchan , Hokkaido





Toyoura City Development Project

Completion: Unbuilt

Use: Residence / Hotel / commercial

Structure: RC

Site Area: 21.78Hecteres (217,825.11sqm

Building Site: Toyoura , Hokkaido





SAAD - sudo associates, architecture and design

Founded by Tomoyuki Sudo, SAAD - sudo associates, architecture and design is an innovative, young design office based in Tokyo with extensive experience in the ski regions of Hokkaido. Sudo's design philosophy and architectural aesthetics is grounded in, and informed by the local culture, materials, and respect for the site and the natural environment. SAAD's portfolio includes residences, holiday homes, hotels, and commercial facilities for clients from Japan, China, Hong Kong, Singapore, and Australia.

Tomoyuki Sudo / Principal

1978	b. in Hokkaido, Japan
2005	Southern California Institute of Architecture [Sci-Arc] (Los Angeles, US) - B. Archi
2005-2007	Amphibian Arc (Los Angeles, US)
2009	Architectural Association School of Architecture [AADRL] (London, UK) - M. Archi
2009-2013	Florian Busch Architects (Tokyo, Japan)
2014	established SAAD - sudo associates, architecture and design

Award & Recognition

Outstanding Property Award London (Platinum winner), International Architecture Awards (Second award), Dezeen Awards (Longlisted), The Illuminating Engineering Institute of Japan (Design Award for Light and Lighting), etc...

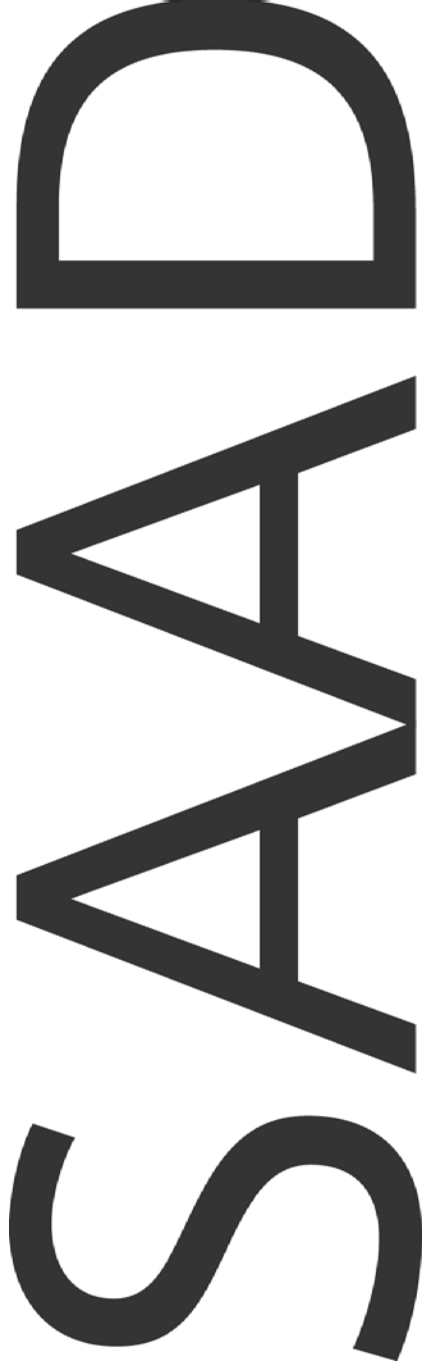



SAAD

sudo associates, architecture and design

151-0063 東京都渋谷区富ヶ谷1-9-5 FTビル 5F
t_03 6416 8576 e_SAAD.info@s-a-a-d.com